

NCTest Required Software

The North Carolina Annual Testing Program requires that NCTest be accessed only through approved, secure platforms. Remote Management software that allows teachers or tech staff to remotely control a student's testing device is NOT to be used during test administration.

- Windows and Mac computers access NCTest through the [NCTest Secure Exam Browser \(SEB.\)](#)
- iPads access NCTest through the [NCTest iPad App](#).
 - The app provides its own security measures.
 - Scroll bars should be set to 'Always show.'
- Chromebooks access NCTest through the [Progressive Web App \(PWA.\)](#)
 - Tests must be administered in Kiosk mode.

Installing the NCTest Secure Exam Browser and iPad App

Testing programs, their technical requirements, and installation instructions for Windows and Mac computers and iPads are accessed through:

<https://center.ncsu.edu/ncinstruct/>

1. Select the testing platform from the dropdown.

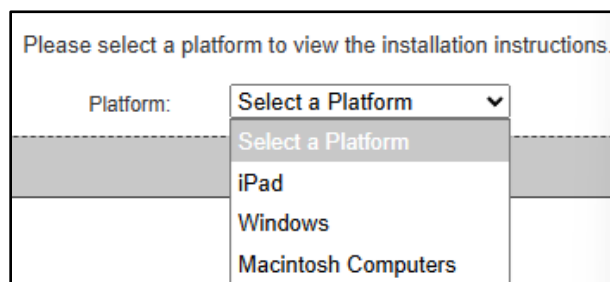

The screenshot shows a web form with the heading "Please select a platform to view the installation instructions." Below the heading is a label "Platform:" followed by a dropdown menu. The dropdown menu is open, showing the following options: "Select a Platform" (the current selection), "iPad", "Windows", and "Macintosh Computers".

2. Ensure the testing device meets the indicated technical requirements.
3. Follow the download and installation instructions until the student login step.
 - Non-public Schools do not use the Student Login section.
 - If there are any issues with the program or installation process, contact the Help Desk.

Installing the Progressive Web App

As of February 20, 2026, Chromebooks must access NCTest through the Progressive Web App. Each school has a unique URL, located in NCTest Admin, they will use to install the PWA on all Chromebook testing devices.

1. If the NCTest Chrome App is installed, uninstall it and restart the device to ensure the caches and App data are fully cleared.
 - The PWA will not function while the NCTest Chrome app is installed.
2. Browse to admin.google.com and log in with an administrator account.
3. Navigate to Devices > Chrome > Apps & Extensions > Kiosks.
4. Click + (Add) in the lower right, and select the Globe (Add By URL.)

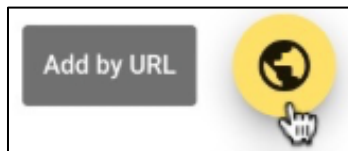

5. Enter the URL from the school's 'Info' tab in NCTest Admin, then click 'Save.'

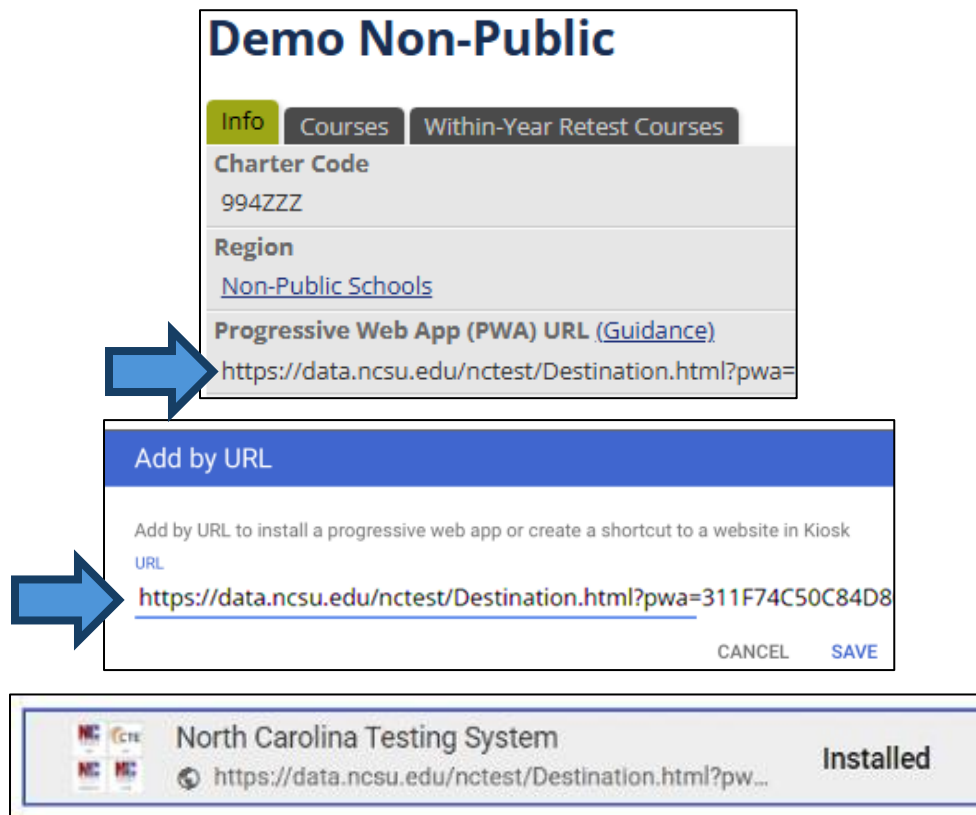

The first screenshot shows the "Demo Non-Public" school profile in NCTest Admin. The "Info" tab is selected, and the "Progressive Web App (PWA) URL (Guidance)" field is highlighted with a blue arrow. The URL is <https://data.ncsu.edu/nctest/Destination.html?pwa=>.

The second screenshot shows the "Add by URL" dialog box. A blue arrow points to the "URL" field, which contains the full URL: <https://data.ncsu.edu/nctest/Destination.html?pwa=311F74C50C84D8>. The "SAVE" button is visible at the bottom right.

The third screenshot shows the installed PWA card in the Chrome OS Kiosk interface. The card displays the "North Carolina Testing System" logo and the URL <https://data.ncsu.edu/nctest/Destination.html?pw...> with the status "Installed" in the top right corner.

- Click on 'North Carolina Testing Systems' to access the kiosk settings and:
 - Set 'Allow the app to Manage Power' to **enabled**.
 - Set 'Web app can run offline' to **off**.

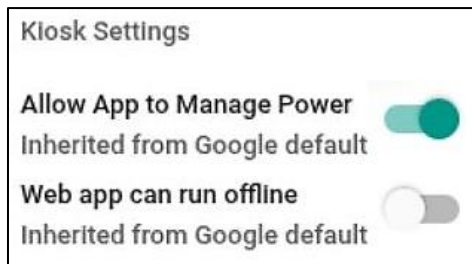

- In the left-hand menu click Settings > Device and select AC Kiosk power settings.

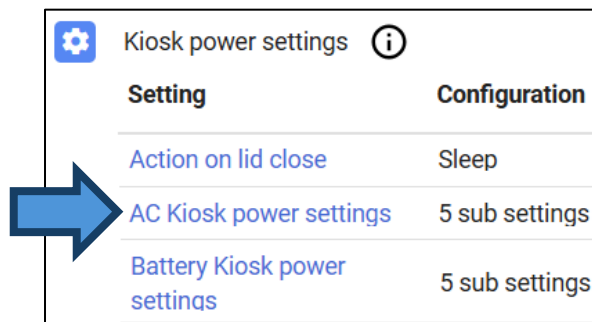

- In the Kiosk Power Settings section:
 - Set 'Action on idle,' to **Do nothing**.
 - Set 'Screen dim timeout' to **0** minutes to prevent dimming.
 - Set 'Screen off timeout' to **0** minutes to prevent the screen from turning off.

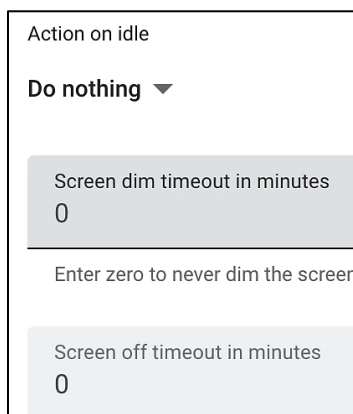

- Click Save.
- Allow Google to push any changes, and then the application can run.
- The app's name should read 'NCTest PWA' in the Apps list.
 - If any other name appears: ensure the old NCTest Chrome app has been uninstalled and restart the device to clear all caches and app data.

- For additional installation support, click the 'Guidance' link on the Info page of NCTest Admin and refer to the 'Step 1: Add web apps to kiosks' section.

Progressive Web App (PWA) URL ([Guidance](#)) 
<https://data.ncsu.edu/nctest/Destination.html?pwa>

- If there are any issues with the program or installation process, contact the Help Desk.

Using the PWA

- Launching the PWA
 - The PWA should be launched from the Apps menu on the Chromebook login screen.
 - Do not log in to the Chromebook or any google account. No login is required to launch the PWA.
- Exiting/Closing the PWA
 - Briefly press the Power button on the Chromebook and choose Log Off or Shut Down.
 - The PWA cannot be closed, suspended, or minimized any other way in order to prevent students from accidentally exiting or disrupting testing sessions.
- Error Code 160
 - This error occurs when launching a testing session. It is caused by entering an incorrect or mistyped URL during PWA installation. PWA URLs are unique to each school, case sensitive, **cannot** be exchanged or shared between schools.
 - To avoid this error, copy/paste the school's unique URL directly from NCTest Admin during installation.
 - To correct the error, reinstall the PWA with the school's correct URL.
 - Contact the Help Desk for further assistance.